

Usage of Oxygen (Accessory)



- O<sub>2</sub> must be turned off when the Nippy 4+ is not in operating mode!
- It is recommended to monitor the oxygen concentrations.

1. Mount the oxygen tube to the connector.



2. Connect the oxygen tube. A click sound is heard when the tube is properly attached.

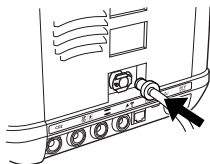

Disconnect:

1. Press the release button to disconnect the oxygen tube.  
2. Remove the tube.  
3. Turn off the oxygen source.

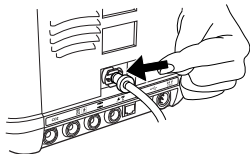

Replacing the Patient Air Inlet Filters

The patient air filters are located in the filter cassette at the side of the ventilator.

Washable Filter (grey): Replace at least once a year, wash at least once a week.

Disposable Filter (white): Replace at least every 4th week, or more often in high pollution or pollen-rich environments.

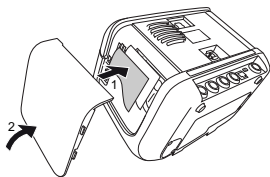

Symbols

SYMBOL	DESCRIPTION
	Internal battery
	Click-in battery level
	Keypad lock activated
	Keypad lock deactivated
	Click-in Humidifier (accessory)
	Heated circuit (accessory)
	Multiple pages

# NIPPY 4+

by Breas

Quick Reference Guide  
Doc. 007768 M-2  
2022-11-30



BREAS

Breas Medical AB · Företagsvägen 1  
SE-435 33 Mölnlycke · Sweden  
Phone +46 31 86 88 00 · Fax +46 31 86 88 10  
Find your local distributor at [www.breas.com](http://www.breas.com)



NIPPY  
by Breas

Specialists in Ventilation and Airway Clearance

## Quick Reference Guide



This is not a complete guide for the Nippy 4+. See your manual for complete instructions.

### Switch On/Off

Press the On/Off button on the side panel.

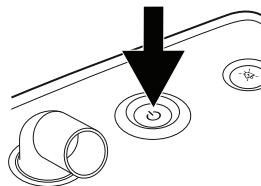

### Connect the Patient Circuit



Always perform a pre-use test when the patient circuit is replaced or modified. If the pre-use test is not prompted at startup, you can start it from the menu.

The leakage from the mask leakage port should be at least 12 l/min at 4 cm H<sub>2</sub>O to prevent rebreathing of exhaled air. The recommended leakage is 20 to 50 l/min at 10 cmH<sub>2</sub>O pressure.

1. Connect the patient circuit to the patient air outlet on the ventilator.

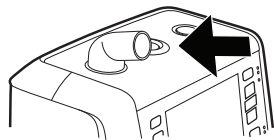

2. Connect the other end of the patient circuit to a leakage port or to a patient interface with integrated leakage port.

### Start/Stop Treatment

1. To start treatment and enter operating mode first press and hold the Start/Stop button on the front panel.

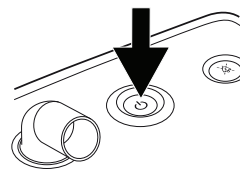

2. Release the Start/Stop button when the progress bar is filled.



3. To stop treatment and enter standby mode first press and hold the Start/Stop button on the front panel.

4. Release the Start/Stop button when the progress bar is filled.



5. Press the Audio Pause button to stop the treatment.

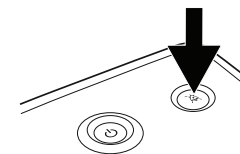

### i-Button

Use the i-button to get explanations about settings and alarms.

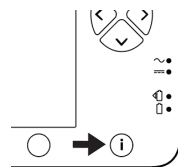

### Connectors

Make sure that the marking is facing up.

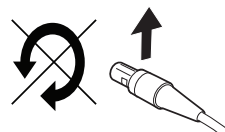

Pull the connector sleeve, not the cable itself to release the connector.

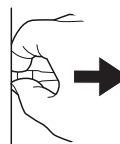

### Connect the Click-in Battery (Accessory)

1. Release the side cover by pressing the button under the handle.

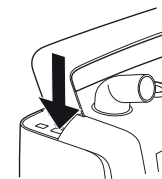

2. Open and remove the side panel.

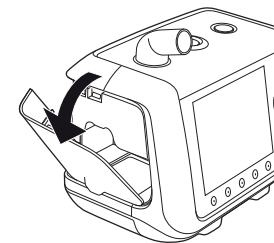

3. Insert the click-in battery. Make sure the latch at the bottom of the click-in compartment is engaged.

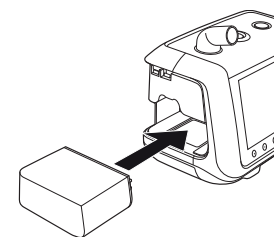

4. Close the side panel. Make sure there is a clicking sound to secure the side panel.

